

REV	DESCRIPTION	DFTR\ DATE	APPROVED
A	UPDATE HOUSINGS	6/14/01	KRISTIN

NOTES:
 1. GEARBOX WEIGHT: 30 LBS.
 2. LUBRICANT: 28 OZ. EP80W90
 3. PERMA FIT GEARS AND PRESS FIT BEARINGS

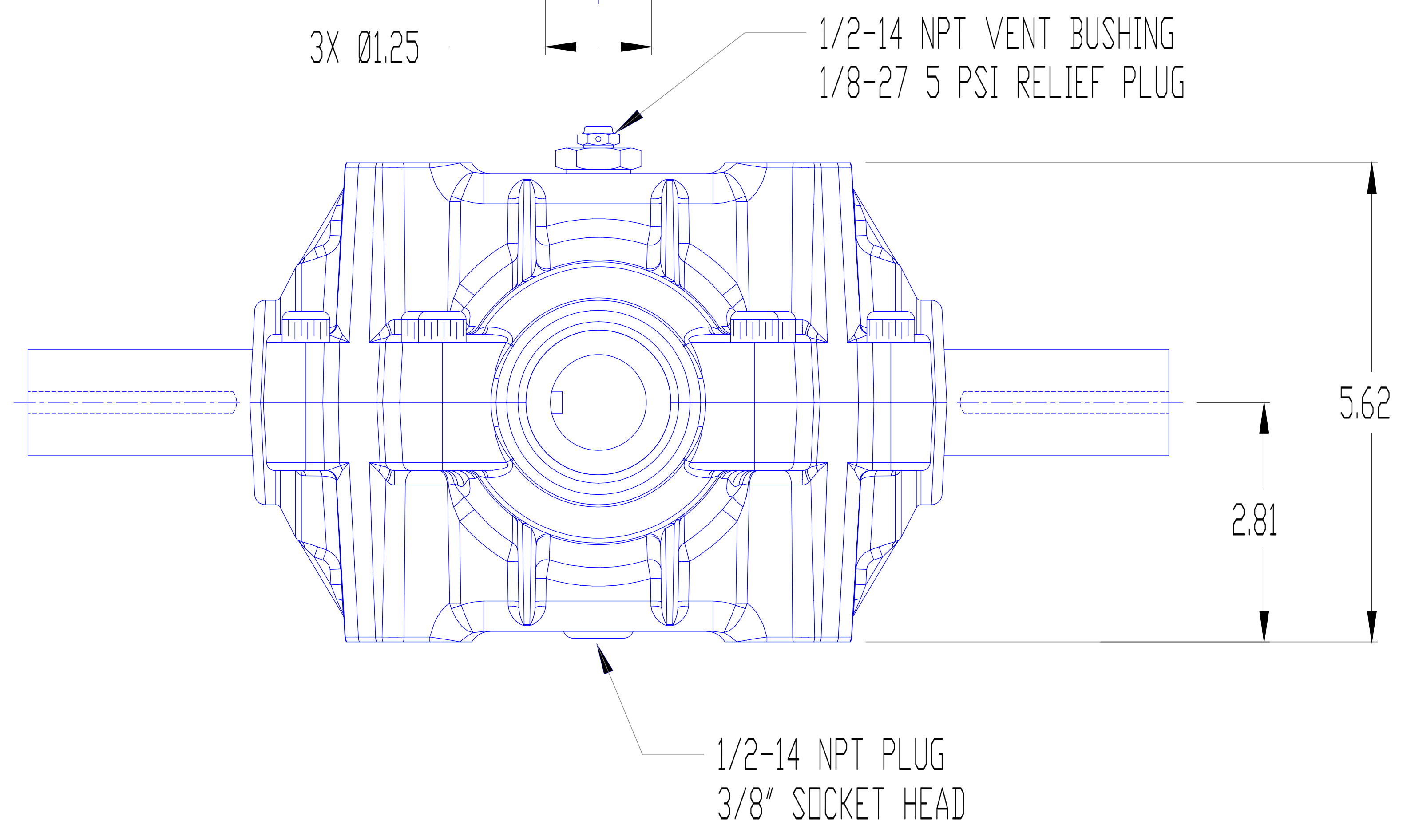

GEAR RATIO: 1:1

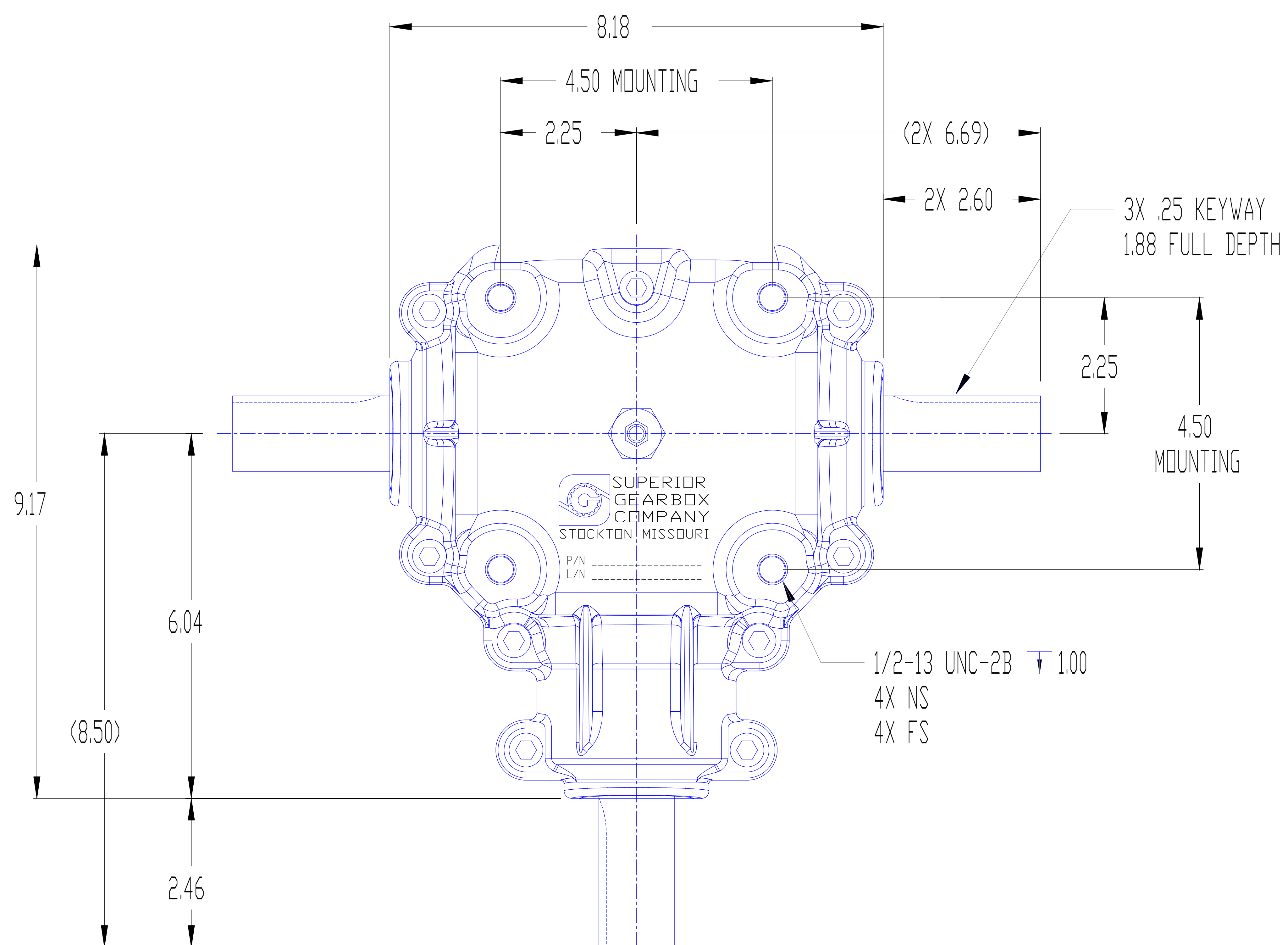
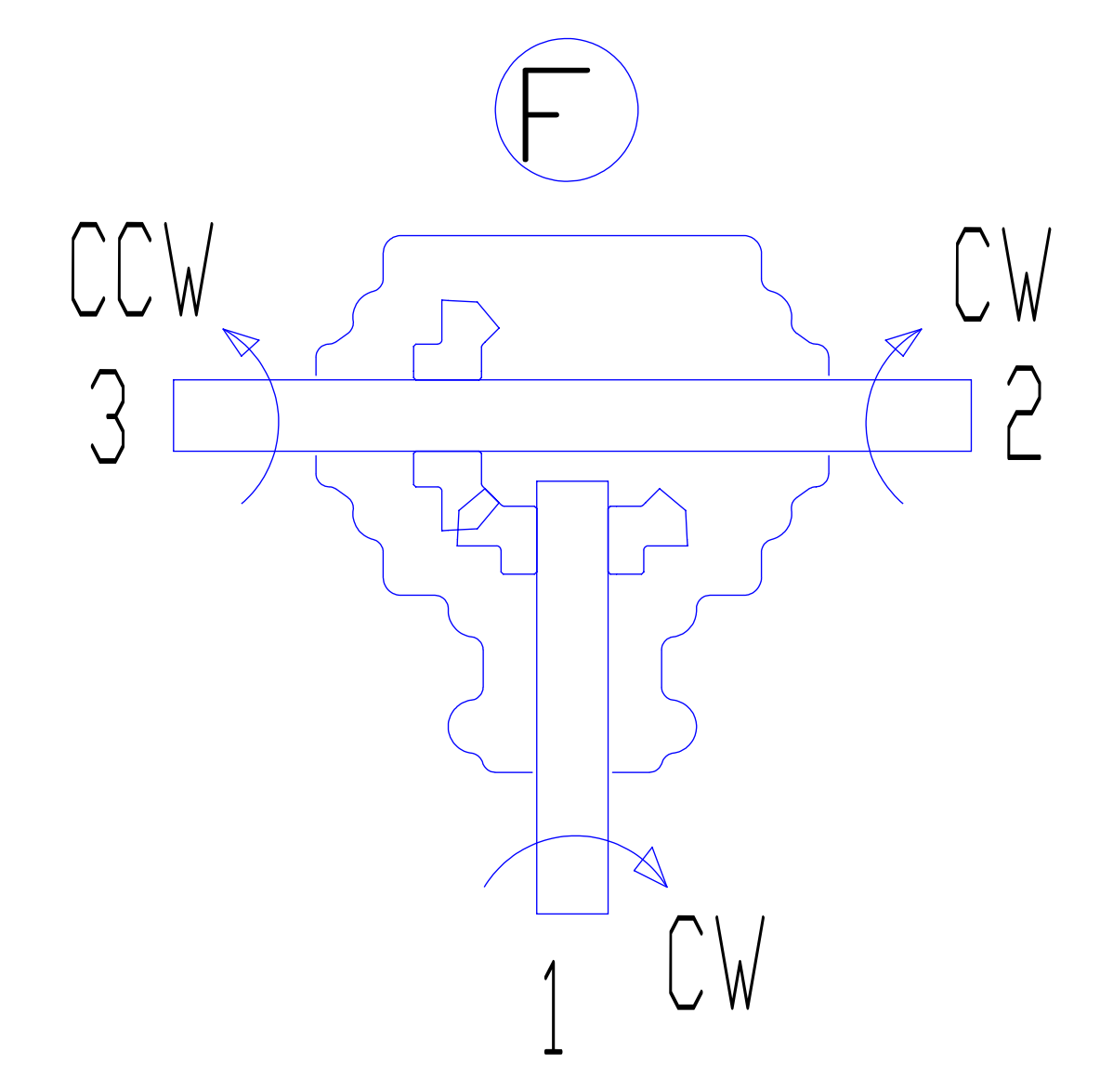

THIS DRAWING CONTAINS INFORMATION THAT IS PROPRIETARY AND CONFIDENTIAL AND THE EXCLUSIVE PROPERTY OF SUPERIOR GEARBOX CO. AND MAY NOT BE REPRODUCED, USED OR DISCLOSED WITHOUT WRITTEN PERMISSION OF THE OWNER

MATERIAL	UNLESS OTHERWISE NOTED	DFTR	DATE
	DIMENSIONS ARE IN INCHES	K.HARPER	6/13/00
	ALL EXTERNAL DIMENSIONS ARE NOMINAL AND DO NOT REPRESENT TOLERANCES. FOR SPECIFIC TOLERANCES ON EXTERNAL DIMENSIONS PLEASE CONTACT YOUR SUPERIOR GEARBOX COMPANY REPRESENTATIVE.	ENGR	DATE
	-INTERPRET DIMENSIONING AND TOLERANCING IN ACCORDANCE WITH ANSI Y14.5M-1982	F. WARE	7/3/00
	-REMOVE ALL BURRS AND BREAK SHARP EDGES	ENGR	DATE
	-MACHINED SURFACES SHALL BE 125	MFG	DATE
	-THREAD DEPTH CALLOUTS INDICATE DEPTH OF FULL THREADS	QC	DATE
	-DIMENSIONAL LIMITS APPLY AFTER FINISH OR HEAT TREAT	MGT	DATE

SIZE	DWG. NO	REV
C	QTR500-9AAF-A0206	A
SCALE	DO NOT SCALE DRAWING	SHEET 1 OF 1